

# H- Flow valve

## Self Sealing Haemostatic Flow Valve

Improved maneuverability and safe handling of guide-wires and flushing in angiography procedures



Interventional  
Cardiology & Radiology



 Elcam Devices  Elcam Stopcocks  Elcam Components

Angiographic catheters require hemostatic flow control devices for safe handling of guide-wires and flushing with heparin and saline in order to avoid in-catheter clotting and potential emboli.

Elcam's H-Flow Valve is a patented Luer activated self-sealing device which allows convenient placement and positioning of common guidewires and micro catheters through an angiographic catheter with minimal blood loss.

## Unique advantages

- Prevents blood loss during insertion and handling of angiographic guide wires and micro catheters
- Enables easy injections and aspirations without opening-closing action
- Convenient insertion of guide wires and micro catheters with the included **Access cap**
- Avoids air penetration into the system

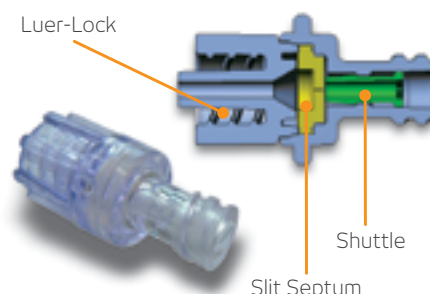

## Product Specifications

- The slit septum inside the HFV functions as a one way valve that prevents blood loss
- Automatically opens and closes upon connecting and disconnecting to a syringe
- Compatible with any angiographic catheter that has a standard female luer connection
- Suitable for any angiographic guide-wire from 0.0014" to 0.38" in diameter
- Can coaxially accept any micro catheters
- Can be used with automatic contrast media injector up to 1200 psi

## Quality System

Elcam's highly automated processes ensure production of consistently high quality products. We operate in strict compliance with regulatory requirements and international quality standards.

The H-flow valve is Biocompatible according to ISO 10993-1

## Regulatory Status:

510(K) cleared (#K034043)

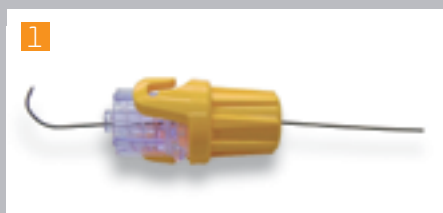

The H-flow valve's access cup functions as a cheater. Once pushed into the slit septum it enables insertion of J-guide wire.



The H-Flow Valve enables insertion of J-guide wire using any cheater.

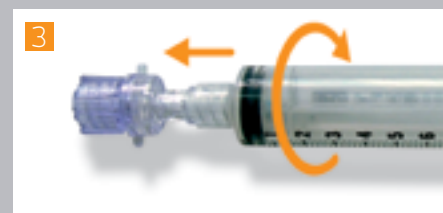

The H-Flow Valve can easily be connected to a Luer lock syringe to enable free bidirectional flow of fluids



[www.elcam-medical.com](http://www.elcam-medical.com)

Head Office / Manufacturer  
Elcam Medical

BarAm 1386000,  
Israel  
Tel: 972 4 698 8120/1/2  
Fax: 972 4 698 0777  
sales@elcam.co.il

USA  
Elcam Medical Inc.

2 University Plaza, Suite 620  
Hackensack, NJ 07601  
Tel: +1 201 4571120  
Fax: +1 201 4571125  
info@elcam-medical.com

Europe  
Elcam Medical Europe

Via Emilia Romagna 15,  
41012 Carpi (Modena) Italy  
Tel: +39 059 697710  
Fax: +39 059 697705  
sales.eu@elcam-medical.com

China  
Elcam China Office

Room 3309, Jinhai Mansion  
No. 89 of Anshun Road,  
Shanghai, PRC. Zip: 200051  
Tel: +86 21 62829967  
Fax: +86 21 62829967  
johnliu02@126.com